

INSTALL 750mmX750mm WA-2L: SINGLE LEFT TURN WITH 600mmX300mm "NO THROUGH ROAD".

INSTALL 750mmX750mm WA-BL CHECKERBOARD WITH 300mmX450mm TC-12 "ROAD CLOSED"

REMOVE EXISTING NO PARKING SIGN

TEMPORARY FENCING TO BE EXTENDED TO WORK PERIMETER

YELLOW LDS REFLECTIVE TAPE TO BE MOUNTED ON TEMPORARY FENCE ALONG WIDTH OF FLETCHER STREET

INSTALL 750mmX750mm TC-30 WITH 300mmX450mm TC-12 "ROAD CLOSED"

REMOVE EXISTING STOP SIGN AND STREET NAMES

INSTALL 600mmX600mm RA-11R: RIGHT TURN PROHIBITED

INSTALL 600mmX600mm RA-11L: LEFT TURN PROHIBITED

DURING CONSTRUCTION PHASE

K:\54005499\C17-5458a - Current Drawing Files\C17-5458a BASE PLAN.dwg 2017/10/21 02:58:27 PM abalacout

LEGAL:	A	ISSUED FOR CITY REVIEW	2017-10-11	BM	
	B	RE-ISSUED FOR CITY REVIEW	2017-10-18	ADB	
	C	RE-ISSUED FOR CITY REVIEW	2017-10-25	ADB	
	D	ISSUED FOR CONSTRUCTION	2017-10-30	ADB	

REV	DESCRIPTION	YYYY-MM-DD	BY	REV	DESCRIPTION	YYYY-MM-DD	BY

PROJ MGR.	ADB
DESIGN/DRANN	BM
PEER REVIEWED	
HORIZ SCALE	1:150
VERT SCALE	

THE WEDLER GROUP

- Abbotsford 1.604.748.0300
- Chilliwack 1.604.792.0551
- Courtenay 1.250.334.3263
- Surrey 1.604.588.1919

WEDLER ENGINEERING

www.wedler.com

RUTH & NAOMI'S MISSION

PROPOSED SITE DEVELOPMENT

48129 PRINCESS AVE

INITIAL ROAD CLOSURE SIGNAGE PLAN

DRAWING NO.	OF 4
C17-5458/A-OS1	
LOCAL GOVERNMENT FILE -FILE-	
PHASE	REVISION
	.D.

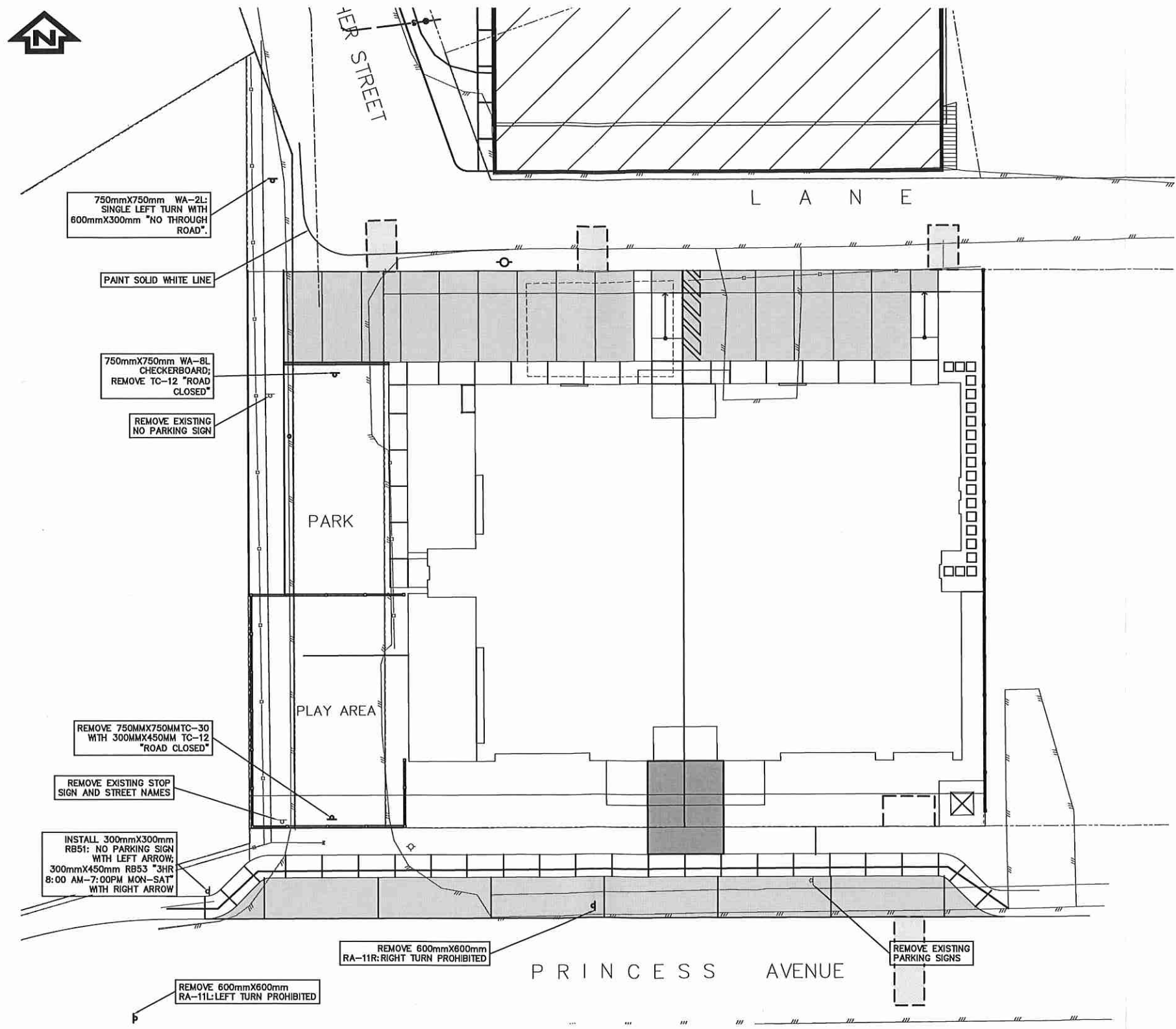

*AFTER CONSTRUCTION
PERMANENT CLOSURE*

K:\4005499\C17-5458a - Ruth & Naomi Bldg Princess Ave\Design - Current Drawing Files\C17-5458a_BASE_PLAN.dwg 2017/10/20 10:04:05 AM dbatesmcault

LEGAL:	A	ISSUED FOR CITY REVIEW	2017-10-11	EM			
	B	RE-ISSUED FOR CITY REVIEW	2017-10-16	ADB			
	C	RE-ISSUED FOR CITY REVIEW	2017-10-25	ADB			
	D	ISSUED FOR CONSTRUCTION	2017-10-30	ADB			
BY/							
TITLE:							

REV	DESCRIPTION	YYYY-MM-DD	BY	REV	DESCRIPTION	YYYY-MM-DD	BY

PROJ. MGR.	ADB
DESIGN/DRAWN	EM
PERM. REVIEWED	
HORIZ. SCALE	1:150
VERT. SCALE	

WEDLER ENGINEERING
www.wedler.com

THE WEDLER GROUP	
■	Abbotsford 1.604.745.0300
■	Chilliwack 1.604.782.0651
■	Courtenay 1.250.334.3263
■	Surrey 1.604.568.1919

RUTH & NAOMI'S MISSION	
PROPOSED SITE DEVELOPMENT	
46129 PRINCESS AVE	
SIGNAGE REMOVAL & REPLACEMENT PLAN	

DRAWING NO.	OF 4
C17-5458/A-OS2	
LOCAL GOVERNMENT FILE -FILE-	
PHASE	REVISION
	.D.